

- Protezione ai transienti su ingresso video e su uscita linea
- Trasmissione su doppino incrociato cat5 a 100 ohm d'impedenza
- Tensione nominale di alimentazione del trasmettitore: 12Vcc (TVAT12); 230Vac (TVAT230)
- Tensione nominale di alimentazione del ricevitore: 12Vcc (TVAT12); 230Vac (TVAT230)
- Assorbimento max TX : 100mA (TVAT12); 13mA (TVAT230V)
- Assorbimento max RX: 85mA (TVAT12); 12mA (TVAT230V)
- Distanza massima di funzionamento: 1500mt (BN) / 880 (COL)
- Ingressi video: 1
- Uscite video: 1
- Dimensioni (LxAxP): 69x61x28mm



## REGOLAZIONI LUNGHEZZA CAVO

- Impostare su ON i DIP-SWITCH come raffigurato nella tabella a seconda della distanza del cavo in modo da avere il migliore segnale video.
- Dopo avere regolato il ricevitore potrà essere necessario modificare leggermente la taratura impostata sul trasmettitore.

## TIPO DI CAVO

Il tipo di cavo da utilizzare è un cavo UTP Cat. 5 (definito secondo gli standard TIA/EIA 568A e ISO/IEC 11801). Con questo cavo si possono coprire lunghe distanze ed è possibile dar passare più segnali video o di telemetria nello stesso cavo (vedi schema).

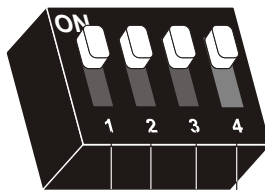

				BN	COL
	1	2	3	Mt.	Mt.
OFF	OFF	OFF	OFF	<100	<60
ON	OFF	OFF	OFF	100	60
OFF	ON	OFF	OFF	200	120
ON	ON	OFF	OFF	300	180
OFF	OFF	ON	OFF	400	240
ON	OFF	ON	OFF	500	300
OFF	ON	ON	OFF	600	360
ON	ON	ON	OFF	700	400
OFF	OFF	OFF	ON	800	460
ON	OFF	OFF	ON	900	520
OFF	ON	OFF	ON	1000	580
ON	ON	OFF	ON	1100	640
OFF	OFF	ON	ON	1200	700
ON	OFF	ON	ON	1300	760
OFF	ON	ON	ON	1400	820
ON	ON	ON	ON	1500	880

NOTA: Le distanze indicate sono indicative e dipendono dalla qualità del cavo e dal livello del segnale video.

## INSTALLAZIONE

Installare i due contenitori su supporti rigidi.

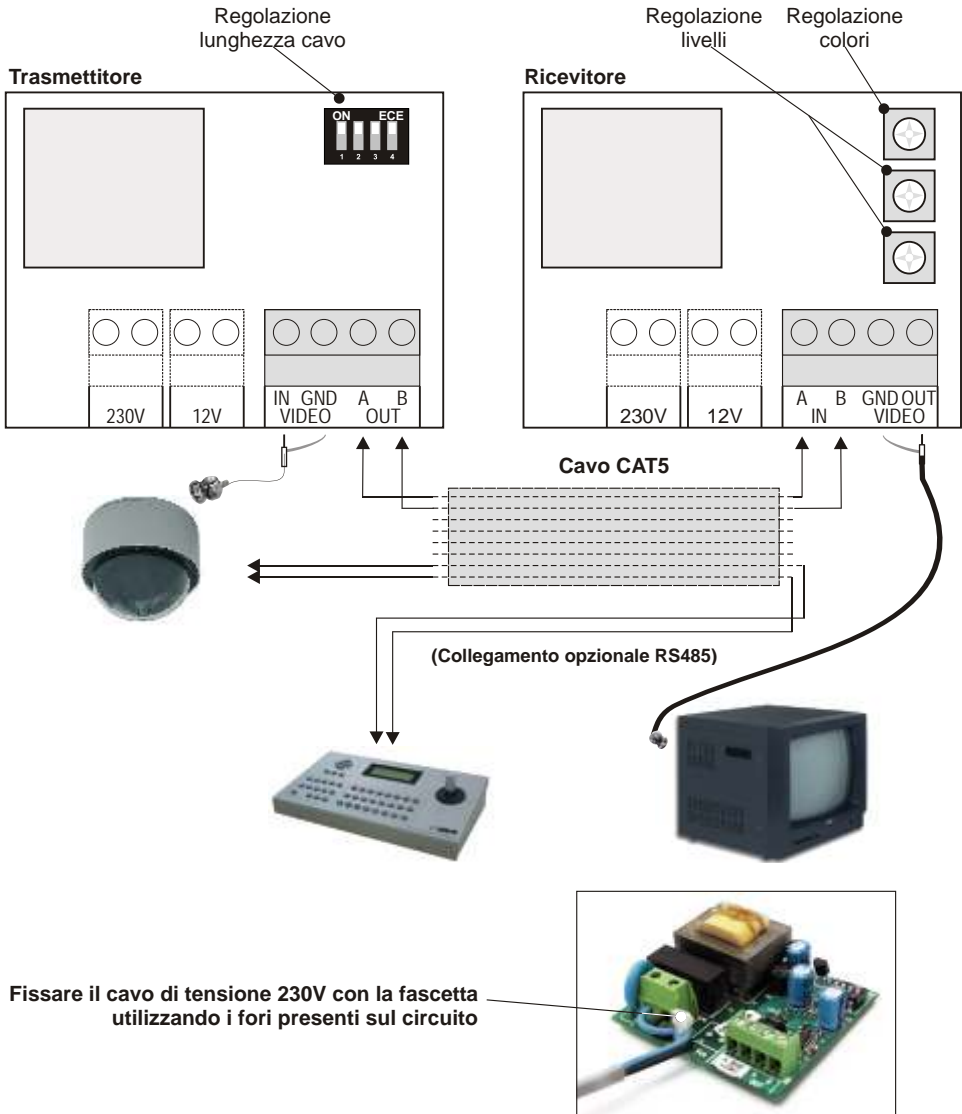



# TVAT12 - TVAT230

**CE** Made in Italy  
EMC 89/336/CEE

12Vdc / 230Vac 1500mt video TX / RX on CAT5 twisted pair

- Protection against burst tensions on video input and line output.
- Transmission on CAT5 twisted pair at 100ohm impedance.
- Transmitter operating voltage: 12Vdc (TVAT12); 230Vac (TVAT230)
- Receiver operating voltage: 12Vdc (TVAT12); 230Vac (TVAT230)
- TX max absorption : 100mA (TVAT12);13mA(TVAT230V)
- RX max absorption: 85mA (TVAT12); 12mA (TVAT230V)
- Maximum operating gap: 1500mt (WB) / 880 (COL)
- Video inputs: 1
- Video outputs: 1
- Dimensions (WxHxD): 69x61x28mm



## LENGTH CABLE REGULATION

- Set the DIP-SWITCH to the ON position as illustrated in the table according to the distance of the cable so as to have the best video signal.
- After having regulated the receiver, it could be necessary to modify lightly the calibration set up on the transmitter.

## CABLE TYPE

The cable to be used is UTP Cat. 5 (defined by TIA/EIA 568A and ISO/IEC 11801 standards). This cable allows you to cover long distances. Moreover, several video or telemetry signals can pass along the same cable (see scheme).

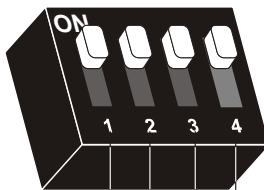

1	2	3	4	WB Mt.	COL Mt.
OFF	OFF	OFF	OFF	<100	<60
ON	OFF	OFF	OFF	100	60
OFF	ON	OFF	OFF	200	120
ON	ON	OFF	OFF	300	180
OFF	OFF	ON	OFF	400	240
ON	OFF	ON	OFF	500	300
OFF	ON	ON	OFF	600	360
ON	ON	ON	OFF	700	400
OFF	OFF	OFF	ON	800	460
ON	OFF	OFF	ON	900	520
OFF	ON	OFF	ON	1000	580
ON	ON	OFF	ON	1100	640
OFF	OFF	ON	ON	1200	700
ON	OFF	ON	ON	1300	760
OFF	ON	ON	ON	1400	820
ON	ON	ON	ON	1500	880

NOTE: The indicated distances are approximate and depend on the quality of the cable and on the level of the video signal.

ENGLISH

## INSTALLATION

Install the two bases on rigid supports

